

FOR CONTINUATION SEE SHEET 2

CURVE TABLE

NO.	RADIUS	ARC	DELTA	TANGENT	CHORD	CHORD-BEARING
61	50.00	40.02	45°51'33"	21.15	38.96	N 0° 0' 0" W
62	287.00	49.02	09°47'09"	24.57	48.96	S 81°54'16" W
63	360.00	90.50	14°24'13"	45.49	90.26	S 79°35'44" W
64	480.00	408.89	48°48'26"	217.77	396.64	S 0° 0' 0" W
65	3000.00	206.28	03°56'23"	103.18	206.24	S 0° 0' 0" W
66	500.00	242.88	27°49'54"	123.88	240.50	N 00°55'38" E
67	290.00	84.61	16°43'03"	42.61	84.32	S 85°22'12" W
68	310.00	115.44	21°20'07"	58.39	114.77	S 83°03'41" W
69	288.00	31.31	34°30'39"	89.46	170.87	S 0° 0' 0" W
70	520.00	71.16	07°52'26"	35.79	71.41	N 0° 0' 0" W
71	25.00	36.97	84°44'10"	22.80	33.69	N 0° 0' 0" W
72	3025.00	208.00	3°56'23"	104.04	207.96	S 0° 0' 0" W
73	25.00	55.15	126°23'26"	49.48	44.63	S 110°57'42" E
74	50.00	188.84	216°23'26"	---	95.00	S 56°57'42" E
75	525.00	255.02	27°49'54"	130.08	252.52	N 00°55'38" E
76	25.00	39.27	90°00'00"	25.00	35.36	N 62°36'23" W
77	25.00	39.27	90°00'00"	25.00	35.36	N 72°23'37" E
78	335.00	84.22	14°24'13"	42.33	83.99	N 79°35'44" E
79	312.00	53.28	09°47'09"	26.71	53.22	N 81°54'16" E
80	25.00	39.27	90°00'00"	25.00	35.36	S 57°59'19" E
81	25.00	39.27	90°00'00"	25.00	35.36	S 32°00'41" W
82	265.00	77.32	16°43'03"	38.94	77.05	S 85°22'12" W
83	335.00	124.75	21°20'07"	63.10	124.02	S 83°03'41" W
84	25.00	36.97	84°44'10"	22.80	33.69	N 0° 0' 0" W
85	520.00	149.91	16°43'03"	75.48	149.39	N 0° 0' 0" W
86	25.00	39.27	89°52'37"	24.95	35.32	N 0° 0' 0" W
87	263.00	263.00	135°55'14"	32.14	63.74	S 0° 0' 0" W
88	50.00	43.34	49°39'42"	23.14	41.99	S 54°22'14" E
89	50.00	228.58	261°56'04"	---	75.51	N 19°29'35" E
90	50.00	31.31	35°52'42"	16.19	30.80	S 66°27'54" W
91	313.00	104.09	19°03'14"	52.53	103.61	N 0° 0' 0" W
92	25.00	35.38	81°05'38"	21.39	32.50	N 0° 0' 0" W
93	313.00	36.75	04°02'59"	18.38	36.75	N 0° 0' 0" W
94	25.00	39.27	90°00'00"	25.00	35.36	N 27°23'37" E
95	285.00	106.13	21°20'07"	53.68	105.51	N 83°03'41" E
96	318.00	91.91	16°43'03"	46.28	91.58	N 85°22'12" E
97	25.00	39.27	90°00'00"	25.00	35.36	S 79°59'19" E
98	475.00	230.73	27°49'54"	117.69	228.47	N 00°55'38" E
99	25.00	39.27	90°00'00"	25.00	35.36	S 59°50'35" W
100	2975.00	204.56	03°56'23"	102.32	204.52	N 0° 0' 0" W
101	50.00	123.24	141°13'38"	142.09	94.33	N 0° 0' 0" W
102	25.00	39.27	90°00'00"	25.00	35.36	S 62°36'23" E
103	25.00	39.27	90°00'00"	25.00	35.36	S 27°23'37" E
104	50.00	36.14	41°24'35"	18.90	35.36	N 86°54'05" W
105	50.00	229.35	262°49'10"	---	75.00	S 17°36'23" E
106	50.00	36.14	41°24'35"	18.90	35.36	N 51°04'20" E
107	25.00	39.27	90°00'00"	25.00	35.36	S 62°36'23" E
108	440.00	89.84	11°41'56"	45.08	89.69	S 0° 0' 0" W
109	25.00	56.81	130°11'35"	53.85	45.35	S 0° 0' 0" W
110	50.00	211.73	242°37'19"	82.20	85.44	S 0° 0' 0" W
111	25.00	56.81	130°11'35"	53.85	45.35	S 0° 0' 0" W
112	440.00	142.00	18°29'29"	71.62	141.39	S 0° 0' 0" W
113	40.00	30.55	43°45'42"	16.06	29.81	S 0° 0' 0" W
114	40.00	30.55	43°45'42"	16.06	29.81	S 0° 0' 0" W
115	42.00	27.78	37°53'50"	14.42	27.28	S 0° 0' 0" W
116	42.00	31.71	43°15'33"	16.65	30.96	S 0° 0' 0" W

SITE DISTANCE EASEMENT DATA

ST-3 S 12°37'46" E 105.36'
 Δ = 11°41'56" R = 440.00' T = 45.08' L = 89.84'
 N 17°36'23" W 15.75'

ST-4 N 23°11'58" E 195.88'
 Δ = 24°38'18" R = 440.00' T = 96.09' L = 189.21'
 Δ = 20°10'39" R = 25.00' T = 4.45' L = 8.80'

MONTERRA HILLS
 HIGHLANDS WASH
 LOTS 1-187, BLOCKS A,B,C & COMMON AREAS A,B,C
 AS REC. IN M&P BK. 42 PG. 30

11700-N.

COMMON AREA "A"
 21,632 S.F.

MONTERRA HILLS
 BLOCK A

LOTS 1-187, BLOCKS A,B,C & COMMON AREAS A,B,C
 AS REC. IN M&P BK. 42 PG. 30

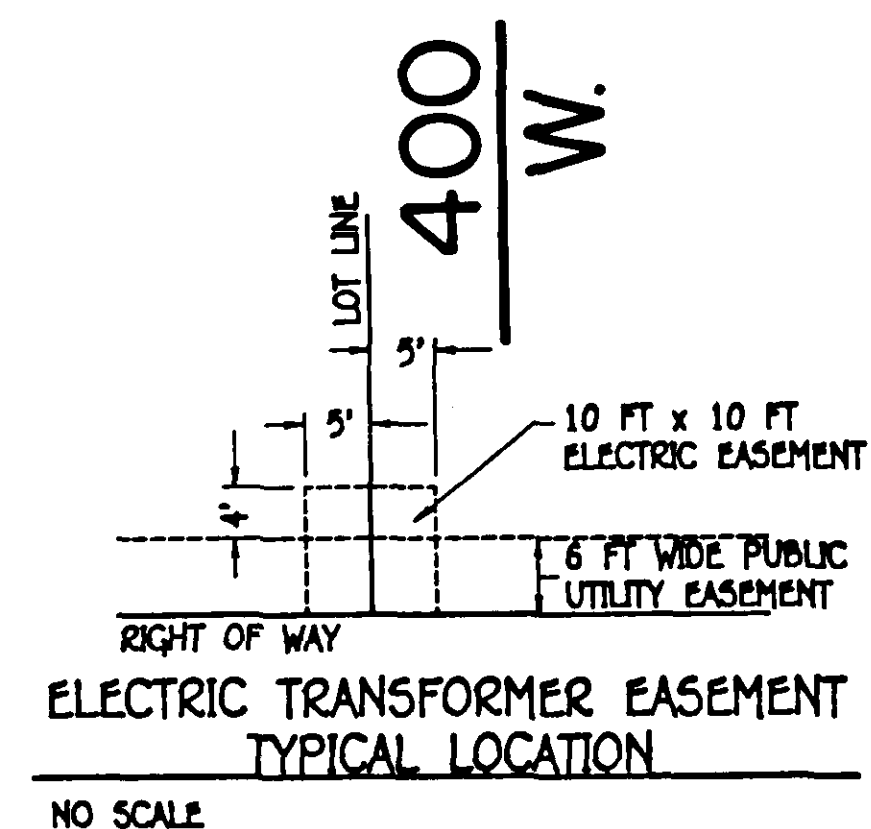

MONTERRA HILLS
 HIGHLANDS WASH
 LOTS 1-187, BLOCKS A,B,C & COMMON AREAS A,B,C
 AS REC. IN M&P BK. 42 PG. 30

Greiner Engineering Services, Inc.
 1991 RONALD L. EWING, JR.
 1991 T. WAYNE ASHBY

REF. NOS.: C012-87-66, C09-85-87,
 C09-86-93 & C012-86-46

APRIL, 1994 E0221.02 SHEET 3 OF 3